



**IMPORTANT  
PLEASE READ**

Select the correct insert based on the type of wipes you will be dispensing:

**BLACK Small Opening Insert**

11019 Roxton Scent Free  
Sanitizing Wipes



**GREY Large Opening Insert**

11009 Roxton Premium Health  
Canada approved wipes

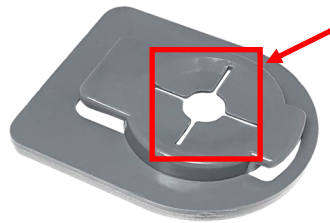

**TO ATTACH THE INSERT:**



1

Open the dispenser using the key provided. Line up the curved opening at the top of the dispenser with the large notch in the insert.



2

Push the insert in until it snaps in place.



3

Close the dispenser door until it locks.

**IF YOUR EXISTING WALL-MOUNT DISPENSER USES A TRAY AND NOZZLE, YOU WILL NEED TO REMOVE IT BEFORE ATTACHING THE NEW INSERT.**

Follow these instructions to remove the tray and nozzle.

(Tools Required: Needle nose pliers)



1

Open the dispenser using the key provided. You can keep the unit mounted to the wall.

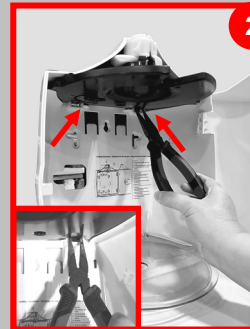

2

Use needle nose pliers to unhook the 2 sets of plastic clips at the back of the black tray.

Once the clips unlatch, gently slide the tray forward to remove.

Follow the steps above to attach the new insert.